



IMPACT

Integrative Medicine : Physical Activity is a Core Tip

June 16. 2016, Oceanus Arthall, Haeundae, Busan, South Korea

INTEGRATIVE MEDICINE RESEARCH (KOREA INSTITUTE OF ORIENTAL MEDICINE) COLLEGE OF MEDICINE, BUSAN PAIK HOSPITAL INJE UNIVERSITY KOREAN
PHYSIOLOGICAL SOCIETY KOREAN SOCIETY OF EXERCISE PHYSIOLOGY CARDIOVASCULAR AND METABOLIC DISEASE CENTER, INJE UNIVERSITY YONSEI INSTITUTE
OF SPORTS SCIENCE & EXERCISE MEDICINE LEADING-EDGE RESEARCH CENTER FOR DIABETES AND METABOLIC DISEASE, RESEARCH INSTITUTE OF AGING AND
METABOLISM OF KNU SCHOOL OF MEDICINE



Invitation

Dear Friends and Colleagues,

We cordially invite you to the IMPACT (Integrative Medicine: Physical Activity is a Core Tip) 2016 Symposium. The 2016 IMPACT Symposium will be held on June 16, 2016 at the Oceanus Arthall, Haeundae, Busan, South Korea. The 2016 IMPACT Symposium is open to all members of the sponsoring and supporting societies, as well as non-members with an interest in research and exercise related-medicine.

The 2016 IMPACT Symposium will bring together a consortium of professionals and international experts from leading physiology groups in the field of medicine, physical activity and exercise. We will discuss current issues and innovations within the area of integrative medicine associated with physical activity. It will also provide an opportunity for building professional networks. Outstanding speakers and well known experts from around the globe will share their knowledge and skills. It is our belief that your participation will help make the 2016 IMPACT Symposium a success.

We are looking forward to seeing you soon at the 2016 IMPACT Symposium in Busan, South Korea.

Yours sincerely

Jin Han, M.D., Ph.D.

On behalf of Organizing Committee of 2016 IMPACT



■ Organization

- Organizing Committee

Jin Han, M.D., Ph.D. (Inje University)
Sun Mi Choi, O.M.D., Ph.D. (Korea Institute of Oriental Medicine)
Hyo Bum Kwak, Ph.D. (Inha University)
In Deok Kong, M.D., Ph.D. (Yonsei University)
Jin Hwan Yoon, Ph.D. (Hannam University)
In Kyu Lee, M.D., Ph.D. (Kyungpook National University)
Nari Kim, M.D., Ph.D. (Inje University)
Sung Joon Kim, M.D., Ph.D. (Seoul National University)
P. Darrell Neuffer, Ph.D. (East Carolina University)

- Scientific Program Committee

Jin Han, M.D., Ph.D. (Chair, Inje University)
Hyo Bum Kwak, Ph.D. (Inha University)
Dae Yun Seo, Ph.D. (Inje University)
Jin Hwan Yoon, Ph.D. (Hannam University)
Nari Kim, M.D., Ph.D. (Inje University)
P. Darrell Neuffer, Ph.D. (East Carolina University)

- Advisory Board

Byoung Doo Rhee, M.D., Ph.D. (Inje University)
Hyoweon Bang, M.D., Ph.D. (Chung-Ang University)
Chang Hyun Jang, Ph.D. (Sunmoon University)
Hye Jung Lee, O.M.D., Ph.D. (Korea Institute of Oriental Medicine)
Yung E Earm, M.D., Ph.D. (Seoul National University)

- International Advisory Board

David A. Hood, Ph.D. (School of Kinesiology and Health Science, York University, Canada)
P. Darrell Neuffer, Ph.D. (Dept. of Physiology, East Carolina University, USA)
John P. Thyfault, Ph.D. (Dept. of Molecular & Integrative Physiology, University of Kansas, USA)
Thomas Solomon, Ph.D. (Institute of Metabolism and Systems Research, University of Birmingham, UK)
Paul J. Fadel, Ph.D. (Dept. of Kinesiology, University of Texas, USA)
Ajay Chawla, M.D., Ph.D. (Dept. of Physiology and Medicine, University of California, San Francisco, USA)

■ Organized by

Korean Physiological Society
Integrative Medicine Research
Korea Institute of Oriental Medicine
Korean Society of Exercise Physiology
Yonsei Institute of Sports Science & Exercise Medicine
College of Medicine, Busan Paik Hospital, Inje University
Cardiovascular and Metabolic Disease Center, Inje University
Leading-edge Research Center for Diabetes and Metabolic Disease,
Research Institute of Aging and Metabolism, Kyungpook National University



- Date: June 16 (Thursday), 2016
- Place: Oceanus Arthall, Haeundae, Busan, South Korea

| | | |
|-------------|--|---|
| 10:00~11:00 | Registration | |
| 11:00~11:30 | Opening Ceremony Moderator: Hyo Bum Kwak (Inha University) | |
| | <ul style="list-style-type: none"> • Opening Address: Hye Jung Lee (Korea Institute of Oriental Medicine) • Welcome Address: Yung E. Earm (Seoul National University) Hyoweon Bang (Chung-Ang University) Chang Hyun Jang (Sunmoon University) • Congratulatory Remarks: Sang Hoon Oh (Busan Paik Hospital) Byoung Doo Rhee (Inje University) | |
| Session I | Chairs: Sun Mi Choi (Korea Institute of Oriental Medicine), Hyo Bum Kwak (Inha University) | |
| 11:30~12:10 | Mitochondrial turnover in muscle during exercise and chronic disuse | David A. Hood (York University, Canada) |
| 12:10~12:50 | Bioenergetics: adaptive responses to acute exercise and exercise training | P. Darrell Neuffer (East Carolina University, USA) |
| 12:50~14:00 | Lunch | |
| Session II | Chairs: Han Chae (Pusan National University), Seung Jun Choi (Kyungsung University) | |
| 14:00~14:40 | Hepatic fitness and metabolic health | John P. Thyfault (University of Kansas, USA) |
| 14:40~15:20 | Is it sufficient to simply "recommend" exercise as part of type 2 diabetes treatment? | Thomas Solomon (University of Birmingham, UK) |
| 15:20~16:00 | Vascular consequences of physical inactivity | Paul J. Fadel (University of Texas, USA) |
| 16:00~16:20 | Coffee Break | |

| | | |
|--------------------|---|---|
| Session III | Chairs: Nari Kim (Inje University), Wook Song (Seoul National University) | |
| 16:20~17:00 | Innate immune regulation of metabolism | Ajay Chawla (University of California, San Francisco, USA) |
| 17:00~17:15 | Role of PDK (Pyruvate Dehydrogenase Kinase) in muscle insulin resistance | In Kyu Lee (Kyungpook National University) |
| 17:15~17:25 | Phytonutrient increases mitochondrial biogenesis with AMPK activation in high-fat diet-induced obese rats | Yangha Kim (Ewha Women University) |
| 17:25~17:35 | Loss of myogenic response and changes in the ion channel currents in hind limb paralyzed skeletal arteries and their recovery by exercise training | Sung Joon Kim (Seoul National University) |
| Session IV | Chairs: In Kyu Lee (Kyungpook National University), Yangha Kim(Ewha Women University) | |
| 17:35~17:45 | Effects of ice application on nutritive blood flow and local metabolic response in skeletal muscle after resistance exercise | Chang Keun Kim (Korea National Sport University) |
| 17:45~17:55 | Exercise heart rate reserve and recovery as predictors of incident type 2 diabetes | Sae Young Jae (University of Seoul) |
| 17:55~18:05 | Moderate exercise training alleviates obese-induced metabolic complication by inhibition of macrophage infiltration and inflammation production in adipocytes | Wanglok Lee (Chungnam National University) |
| 18:05~18:15 | Correlates of children obesity | Yoonsuk Jekal (Jeju National University) |
| 11:00~18:30 | Poster Exhibition | |
| | • Closing Address: Jin Han (Inje University) | |
| 18:30~22:00 | Closing Ceremony & Welcome Reception | |

■ 사전등록방법

- 마감: 2016년 5월 27일(금) 오후 5시까지
- 사무국으로 등록양식을 작성하여 이메일로 제출 후 등록비를 입금하여 주십시오.
- 총 등록인원은 100명으로 제한하고 선착순으로 신청 마감합니다.
- 등록은 계좌송금에 의한 사전등록만 가능하고 현장등록은 불가능합니다.
- 2인 이상 합산입금을 원하시는 경우에는 송금인 성명을 적어 주시거나 사무국으로 알려주십시오. (등록은 개인별로 해주십시오).

■ 등록비

- 100,000원 (신분구분 없이 동일)
- 영수증, 명찰, 프로그램 북 등은 학회당일 등록데스크에서 배부합니다.
- 무료 제공 사항: 점심, 저녁 환영 만찬, 커피 및 다과

■ 송금계좌번호

- 우리은행 1005-8022-05289 (주식회사 더 플랜비)
- 본 학회는 사업자등록증과 고유번호증이 없는 비영리단체로서 등록비의 카드결제가 불가하며 세금계산서 및 계산서는 발행되지 않습니다. 조직위원장 명의의 영수증과 명찰 등은 학회당일 등록데스크에서 배부합니다.

■ 취소 및 환불규정

- 등록 취소 시, 6월 3일(금)까지는 50% 환불해드리며, 그 이후에는 환불되지 않습니다.

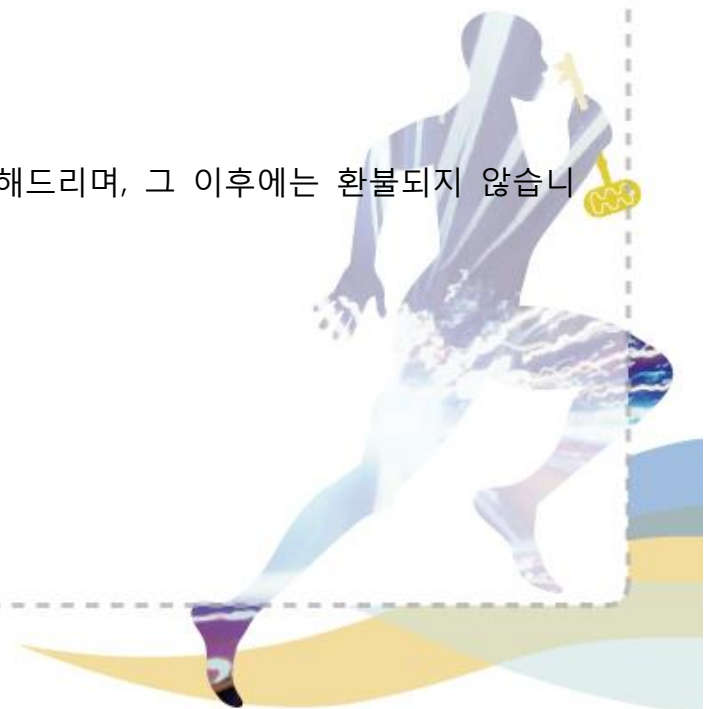

■ 초록접수방법

- 마감: 2016년 5월 27일(금) 오후 5시까지
- 초록접수 양식을 다운받으셔서 워드파일로 작성하신 후 사무국으로 이메일 (ramg6054@gmail.com) 제출해 주시기 바랍니다
- 이미 접수 완료된 초록의 수정에 관해서는 사무국으로 연락하여 주십시오.
- 초록은 영문으로만 작성하고, 본문은 영문 2,000자 이내로 최대 1페이지가 넘지 않도록 해주십시오.
- 초록접수자께서는 반드시 사전등록과 등록비 입금을 해주시기 바랍니다.

☎ 기타 문의사항은 사무국으로 연락주시기 바랍니다.

■ 문의처

- 인제대학교 심혈관대사질환센터(조교 박자원)
- 핸드폰: 010-8013-6054
- 전화: 051-890-8776
(오전 9시~오후 5시, 이외 시간에는 이메일을 이용하여 주십시오)
- 팩스: 051-891-8748
- E-mail: ramg6054@gmail.com
- Website: www.impactsymposium.org



General Information

Venue- **OCEANUS ART HALL**(Conference)



Addr. : 143, Dalmaji-gil, Haeundae-gu, Busan, Korea

Tel. : +82 51 790 1810



Subway: Busan Metro(line2) Haeundaest. or Jungdong > 20minutes on foot

Bus: 1001,1003,38,139,141 > Haeundaest. > 10minutes by taxi

Limousine: ParadiseHotel > 5minutes by taxi

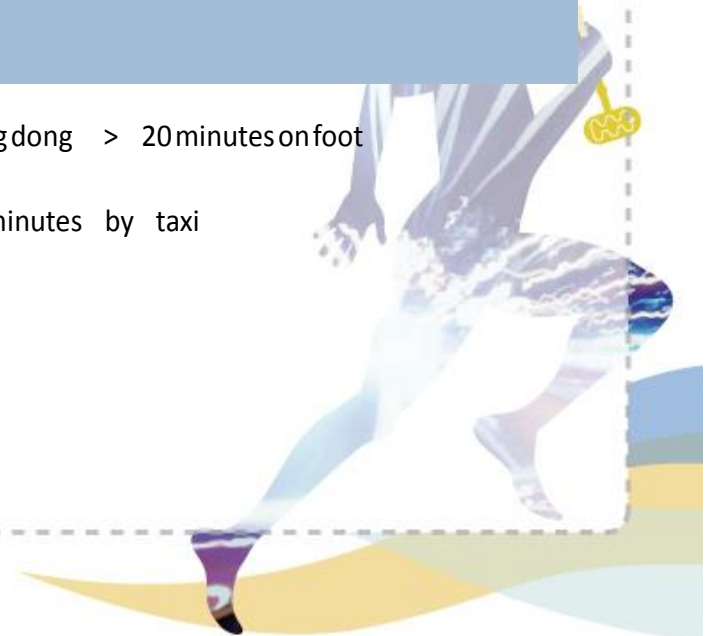

General Information

Venue Guidance

2F Conference hall

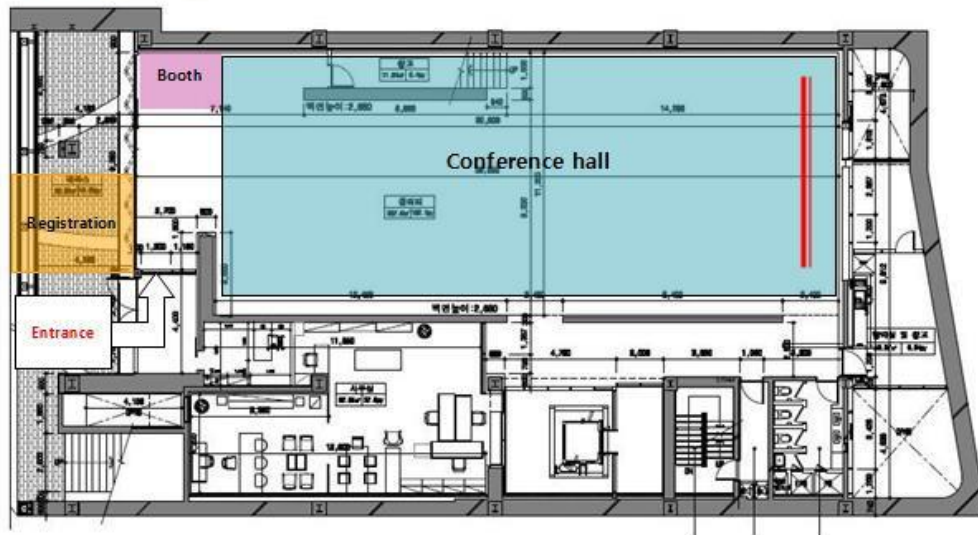

3F Cafeteria

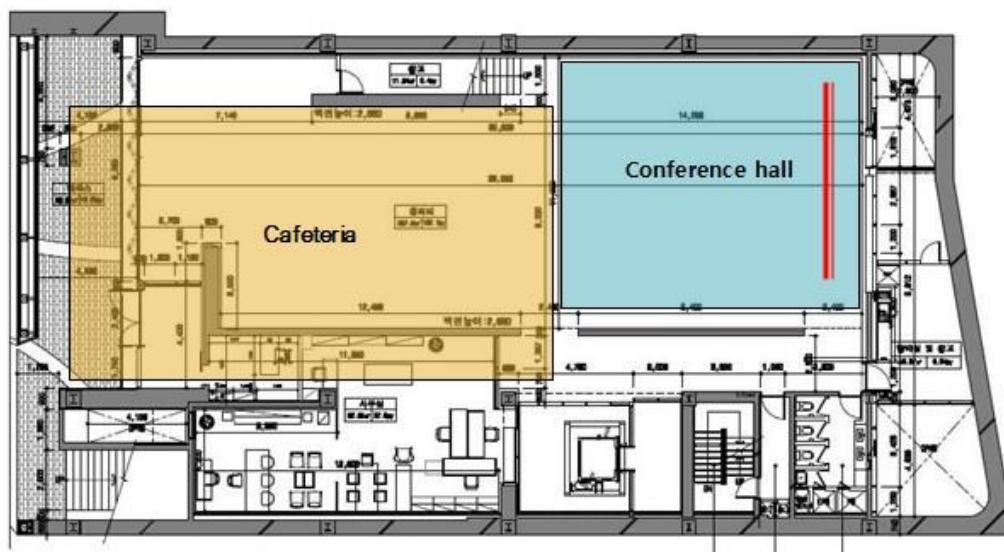

연회장소: **SAINTMARE**

(부산시 수영구 민락동 181-223 바다마루 7층 세인트마레. 051-744-8448)

이동방법:

- 단체버스 (추천): 학회장(오션어스 아트홀) 앞 오후 18:30 출발
- 개별 차량: 상기 주소 참고 (주차 2시간 제공)

연회 메뉴: 유럽식 BBQ (신선한 해산물과 각종 육류)

문의: 사무국 또는 세인트마레 매장 전화

